

CBG

JW Turnberry Resort Aventura, FL

Jan 19-21, 2026



**\*\*\*Advanced ordering ends 12/12/25\*\*\***

Exhibitor Name: \_\_\_\_\_ Booth No. \_\_\_\_\_

**Please visit [www.atlanticshowcases.com](http://www.atlanticshowcases.com) to view all cases offered on order form.**

| TCS Towers:    | Circle: 3000K LED OR 6000K LED | Circle: Black or White | PRICE EACH | TOTAL ITEMS | TOTAL |
|----------------|--------------------------------|------------------------|------------|-------------|-------|
| TCS 2020 Tower |                                |                        | \$800.00   |             |       |
| TCS 1639 Tower |                                |                        | \$900.00   |             |       |
| TCS 1651 Tower |                                |                        | \$950.00   |             |       |
| 2030 Museum    |                                |                        | \$800.00   |             |       |
| 2020 Museum    |                                |                        | \$800.00   |             |       |

| ELITE CASES          | Circle: Black or White | 4' | 5' | 6' |          |  |  |
|----------------------|------------------------|----|----|----|----------|--|--|
| Elite Full Vision    |                        |    |    |    | \$850.00 |  |  |
| Elite Half Vision    |                        |    |    |    | \$850.00 |  |  |
| Elite Quarter Vision |                        |    |    |    | \$850.00 |  |  |

|                                  |             |             |                |          |  |  |  |
|----------------------------------|-------------|-------------|----------------|----------|--|--|--|
|                                  | Full Vision | Half Vision | Quarter Vision |          |  |  |  |
| Elite Corner Case – 39" Sq. Only |             |             |                | \$850.00 |  |  |  |

| CLASSIC CASES          | Black Only | 4' | 5' | 6' |          |  |  |
|------------------------|------------|----|----|----|----------|--|--|
| Classic Half Vision    |            |    |    |    | \$750.00 |  |  |
| Classic Quarter Vision |            |    |    |    | \$750.00 |  |  |

|                                    |             |                |  |          |  |  |  |
|------------------------------------|-------------|----------------|--|----------|--|--|--|
|                                    | Half Vision | Quarter Vision |  |          |  |  |  |
| Classic Corner Case - 34" Sq. Only |             |                |  | \$750.00 |  |  |  |

| PREMIUM ALUMIMUM CASES         | White Only | 4'                  | 5' | 6' |          |  |  |
|--------------------------------|------------|---------------------|----|----|----------|--|--|
| Premium Full Vision            |            |                     |    |    | \$750.00 |  |  |
| Premium Half Vision            |            |                     |    |    | \$750.00 |  |  |
| Premium Quarter Vision         |            |                     |    |    | \$750.00 |  |  |
| Premium Corner Cases – 36" Sq. |            | Quarter Vision Only |    |    | \$750.00 |  |  |

| STANDARD CASES                      | Circle: Black or White | 4'               | 5' | 6' |           |  |  |
|-------------------------------------|------------------------|------------------|----|----|-----------|--|--|
| Standard Full Vision                |                        |                  |    |    | \$650.00  |  |  |
| Standard Half Vision                |                        |                  |    |    | \$650.00  |  |  |
| Standard Quarter Vision             |                        |                  |    |    | \$650.00  |  |  |
| Standard Corner Case – 34" Sq. Only |                        | Half Vision Only |    |    | \$650.00  |  |  |
| Standard Wall Case                  |                        |                  |    |    | \$1000.00 |  |  |
| Standard See-Thru Case              |                        |                  |    |    | \$1050.00 |  |  |
| Standard 2020 Tower                 |                        |                  |    |    | \$800.00  |  |  |

Subtotal

**IF ORDERED AFTER 12/12/25 ADD \$100.00 PER CASE**

7% Sales Tax

TOTAL

Exhibitor Name: \_\_\_\_\_ Booth Number: \_\_\_\_\_

## Placement of Showcases

Back Wall of Booth

Side Wall of Booth

Side Wall of Booth

Booth Opening

### Sample Showcase Layouts

10' X 10' Corner Booths



10' X 20' Booths

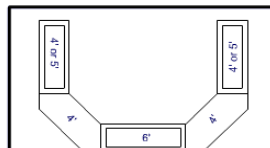
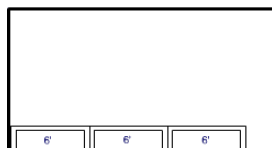

10' X 20' Booths

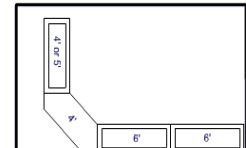
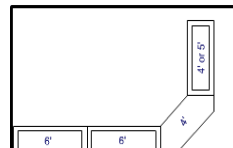

Submit Orders to: Atlantic Rentals and Sales, Corp.  
301 Essex Road ♦ Tinton Falls, NJ 07753 ♦ Phone 732.922.8958 ♦ Fax 732.922.8951  
Email: [info@atlanticshowcases.com](mailto:info@atlanticshowcases.com) ♦ Website: atlanticshowcases.com



Exhibitor Name: \_\_\_\_\_ Booth Number: \_\_\_\_\_

## **PAYMENT INFORMATION**

**Visa/Mastercard/Discover/American Express**

Cardholder's Name: \_\_\_\_\_

Billing Address: \_\_\_\_\_

Phone Number: \_\_\_\_\_

Credit Card Number: \_\_\_\_\_

Expiration Date: \_\_\_\_\_ CVN: \_\_\_\_\_

Email: \_\_\_\_\_

Total Due: \_\_\_\_\_

Date of Sale: \_\_\_\_\_

This agreement must be signed by authorized cardholder. Cardholder acknowledges receipt of goods and/or services in the amount of the Total shown hereon and agrees to perform the obligation set forth in the Cardholder's agreement with issuer.

\_\_\_\_\_  
Authorized Signature

\_\_\_\_\_  
Date

## **DISCLAIMER**

Cases are rented for display purposes only. We do not warranty the safety thereof. We are not liable for contents, damage or breakage after cases have been delivered.

---

Submit Orders to: Atlantic Rentals and Sales, Corp.  
301 Essex Road ♦ Tinton Falls, NJ 07753 ♦ Phone 732.922.8958 ♦ Fax 732.922.8951  
Email: [info@atlanticshowcases.com](mailto:info@atlanticshowcases.com) ♦ Website: atlanticshowcases.com